

TYPE CMAX

GAS or OIL:
1,260,000 – 120,000,000 BTU/HR

Power Flame's Versatile High Capacity Gas / Oil Burner

Low Pressure Firing Head

Added flexibility for low gas pressure applications and reduced blower motor horsepower

The Power Flame CMAX burner offers state-of-the-art technology for maximum combustion efficiency and operating performance when firing all types of oil and gaseous fuels.

Designed for today's firetube and watertube boilers, the CMAX burner utilizes a unique firing head design which provides stable combustion over a wide turndown range (10:1 on gas and 8:1 on air atomized oil.)

The low NOx option using induced flue gas recirculation provides minimal emissions on gaseous and liquid fuels.

The "easy access" door on the burner blast tube allows convenient maintenance of the firing head components without disturbing either the fuel piping or electrical connections.

The bottom or top-entry, gas manifold connection facilitates left or right hand configurations.

Our modular design concept produces added flexibility for a wide range of optional features. All packaged combustion systems are factory fire-tested to ensure cost effective installation and start-up.



Adjustable Firing Head

Produces optimum fuel-air mixture with in the primary combustion zone

Total Access Panel

Swing out, easily removable top and front panels standard. (Optional Nema panel with touch screen shown)



CALL US: 620-421-0480
VISIT: WWW.POWERFLAME.COM
EMAIL: CSD@ASTECINDUSTRIES.COM

POWER FLAME INCORPORATED
2001 S. 21ST ST. PARSONS, KS 67357
FOLLOW US:



STANDARD EQUIPMENT

- Backward inclined blower wheel, Control panel lights (Power, Demand, Main Fuel, and FSG Alarm), control switches and manual potentiometer.
- Gas electric pilot and ignition transformer
- Automatic Burner Controls

GAS BURNER

- Pressure regulators, pilot and main gas cocks
- Adjustable gas firing head

ADDED FEATURES

- Modulation with automatic air control
- Dual gas and oil safety valves
- High and low gas pressure switches
- Characterized gas fuel metering
- IFGR for low NOx operation

Unique firing head produces stable combustion over wide turndown.

AIR ATOMIZED OIL BURNER

- Nozzle assembly with oil and atomizing air trains
- Air compressor
- Remote pump assembly

MODEL CM (Forced Draft Burner)

MODEL CMR (For low centerline applications)

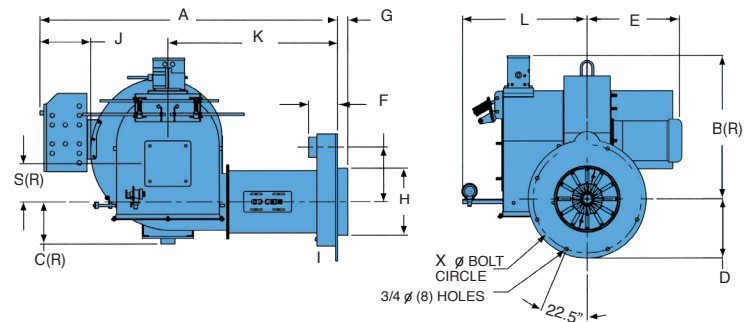
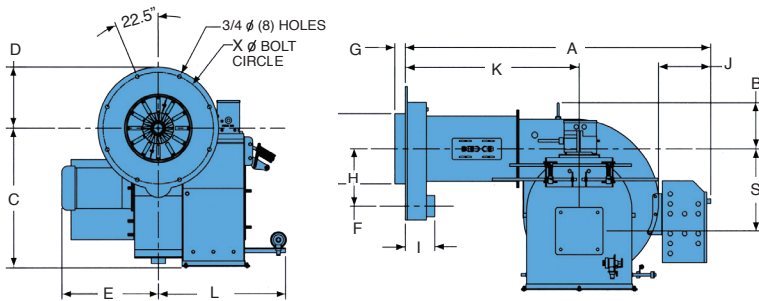

DIMENSIONS (Inches) Standard Models

RATINGS & SPECIFICATIONS

Burner Model	A	B	B(R)	C	C(R)	D	E	F	G****	H	I	J	K	L	S	S(R)	X	CAPACITY*			BLOWER MOTOR H.P.	GAS** PRESS. REQ'D (IN. W.C.)
																		# 2 OIL MPH MAX.	NAT. GAS MBH MAX.	NOMINAL BOILER H.P. MAX.		
CM9-G(O)-30	58	8 3/4	28 1/2	26 15/16	8 5/16	11 3/4	18 13/16	10 13/16	2	13 1/4	5 5/8	9 7/8	33 3/32	24 13/16	15 17/32	7 19/32	21 1/2	90.0	12,600	300	3.0	21.0
CM9A-G(O)-30	58	8 3/4	28 1/2	26 15/16	8 5/16	11 3/4	18 13/16	10 13/16	2	13 1/4	5 5/8	9 7/8	33 3/32	24 13/16	15 17/32	7 19/32	21 1/2	122.0	17,040	406	5.0	44.0
CM9B-G(O)-30	58	8 3/4	28 1/2	26 15/16	8 5/16	11 3/4	18 13/16	10 13/16	2	13 1/4	5 5/8	9 7/8	33 3/32	24 13/16	15 17/32	7 19/32	21 1/2	152.0	21,300	507	7.5	64.0
CM10-G(O)-30	63	11 5/16	32 1/8	28 3/8	7 25/32	11 3/4	21 5/8	10 13/16	2	13 1/4	5 5/8	10 3/16	35 5/8	33	10 1/16	13 3/32	21 1/2	158.0	22,165	528	10.0	73.0
CM10A-G(O)-30	63	11 5/16	32 1/8	28 3/8	7 25/32	11 3/4	21 5/8	10 13/16	2	13 1/4	5 5/8	10 3/16	35 5/8	33	10 1/16	13 3/32	21 1/2	180.0	25,200	600	15.0	93.0
CM10B-G(O)-30	63	11 5/16	32 1/8	28 3/8	7 25/32	11 3/4	21 5/8	11 13/16	2	15 1/8	5 5/8	10 3/16	35 5/8	33	10 1/16	13 3/32	21 1/2	218.0	30,500	726	15.0	120.0
CM10C-G(O)-30	63	11 5/16	32 1/8	28 3/8	7 25/32	11 3/4	21 5/8	11 13/16	2	15 1/8	5 5/8	10 3/16	35 5/8	33	10 1/16	13 3/32	21 1/2	257.0	36,000	857	20.0	128.0
CM11-G(O)-30	68	12 3/4	37 9/16	34 11/16	9 3/16	12 11/16	25 13/16	13 7/32	2	17 1/8	5 11/16	9 3/4	37 7/8	33 1/4	15 13/32	15 13/32	23 3/8	329.0	46,000	1095	25.0	77.0
CM11A-G(O)-30	68	12 3/4	37 9/16	34 11/16	9 3/16	12 11/16	27 1/4	13 7/32	2	17 1/8	5 11/16	9 3/4	37 7/8	33 1/4	15 17/32	15 13/32	23 3/8	378.0	53,000	1260	30.0	101.0
CM12-G(O)-40	84	14 1/4	44 7/8	42 5/16	13 3/16	13 11/16	26 7/8	14 7/32	2	19 1/8	5 3/4	9 3/4	48 5/16	38	18 3/4	18 3/4	25 3/8	429.0	60,000	1430	60.0	140.0
CM12A-G(O)-40	84	14 1/4	44 7/8	42 5/16	13 3/16	13 11/16	26 7/8	14 7/32	2	19 1/8	5 3/4	9 3/4	48 5/16	38	18 3/4	18 3/4	25 3/8	456.0	63,850	1520	75.0	140.0
CM13-G(O)-40	100	16	***	46 1/4	***	14 11/16	22 3/4	15 1/4	2	21 1/4	5 3/4	14	57 1/4	44 5/8	21 7/8	***	27 3/8	540.0	75,600	1800	100.0	280.0
CM14-G(O)-40	100	16	***	46 1/4	***	15 11/16	36 3/16	16 1/4	2	23 1/4	5 3/4	14	57 1/4	44 5/8	21 7/8	***	29 3/8	660.0	92,400	2200	125.0	280.0
CM15-G(O)-40	121	18 1/4	***	49 1/2	***	16 11/16	43 3/8	27 3/8	2	25 1/8	15 1/2	9 13/16	80 1/16	26 1/8	22 13/16	***	31 3/8	860.0	120,000	2800	150.0	280.0

NOTES: Dimensions can vary with optional equipment and system arrangements. Final piping connections should be determined after installation.
 * PFI certified capacities listed are based on +1.00" w.c.(CM9) / +2.50" w.c. (CM10) / +4.00" w.c. (CM11) / +8.00" w.c. (CM12-15) combustion chamber pressure. Refer to capacity curves for derates based upon combustion chamber pressure.
 ** Gas pressures listed are at the inlet to the main shutoff cock and required to obtain PFI certified rating with the standard UL gas train. Optional gas trains are available for lower pressures.
 *** Consult factory
 **** Refer to O & M manual for proper insertion and quarl dimensions.

CALL US: 620-421-0480
 VISIT: WWW.POWERFLAME.COM
 EMAIL: CSD@ASTECINDUSTRIES.COM

POWER FLAME INCORPORATED
 2001 S. 21ST ST. PARSONS, KS 67357
 FOLLOW US:

