

CONVERSION KITS		
PART #	TUBING SIZE	TYPICAL BURNER SIZE
M25001	1/4"	C1, C2, C3
M25002	5/16"	C4, C5
M25003	3/8"	C6, C7, C8
M25004	1/2"	CM9 & LARGER

K7 VALVE NOT INCLUDED IN KIT MUST SPEC OUT SEPARATELY DUE TO SIZING REQUIREMENTS

SPARE TUBING CONNECTORS AND PIPE FITTINGS INCLUDED FOR DIFFERENT SETUPS/REQUIREMENTS

REVISION	REVD CHKD	DATE

AFTER INSTALLATION, PROPER COMBUSTION PERFORMANCE MUST BE VERIFIED BY QUALIFIED BURNER TECHNICIAN

**TOLERANCES**  
 FAB ± 1/32", WELD ± 1/16"  
 ON ALL DIMENSIONS  
 EXCEPT AS NOTED

**Power Flame Inc.**  
 2001 SOUTH 21st STREET  
 PARSONS, KANSAS 67357, USA  
 OFFICE 620.421.0480  
 FAX 620.307.0367  
 www.powerflame.com



**POWER FLAME INC.**  
 AN ASTEC INDUSTRIES COMPANY

DWG. BY: AG	CHKD. BY:	SCALE: 1/8	DATE: 1/16/2024
DO NOT SCALE FROM THIS DRAWING		MATERIAL: SEE BOM TABLE	
TITLE: S SERIES HAUCK VALVE TO K7 VALVE CONVERSION			DWG. NO.: I6662MC SHEET 1
			DWG. SIZE: B APPROX WEIGHT: 146.45 LBS

PROPRIETARY AND CONFIDENTIALITY NOTICE: THE CONTENTS OF THIS TEMPLATE CONSTITUTE PROPRIETARY AND CONFIDENTIAL INFORMATION OWNED BY POWER FLAME INCORPORATED. IT SHALL NOT BE REPRODUCED, IN WHOLE OR IN PART, AND SHALL NOT BE DISCLOSED TO ANYONE OUTSIDE POWER FLAME WITHOUT THE PRIOR EXPRESS APPROVAL OF POWER FLAME.

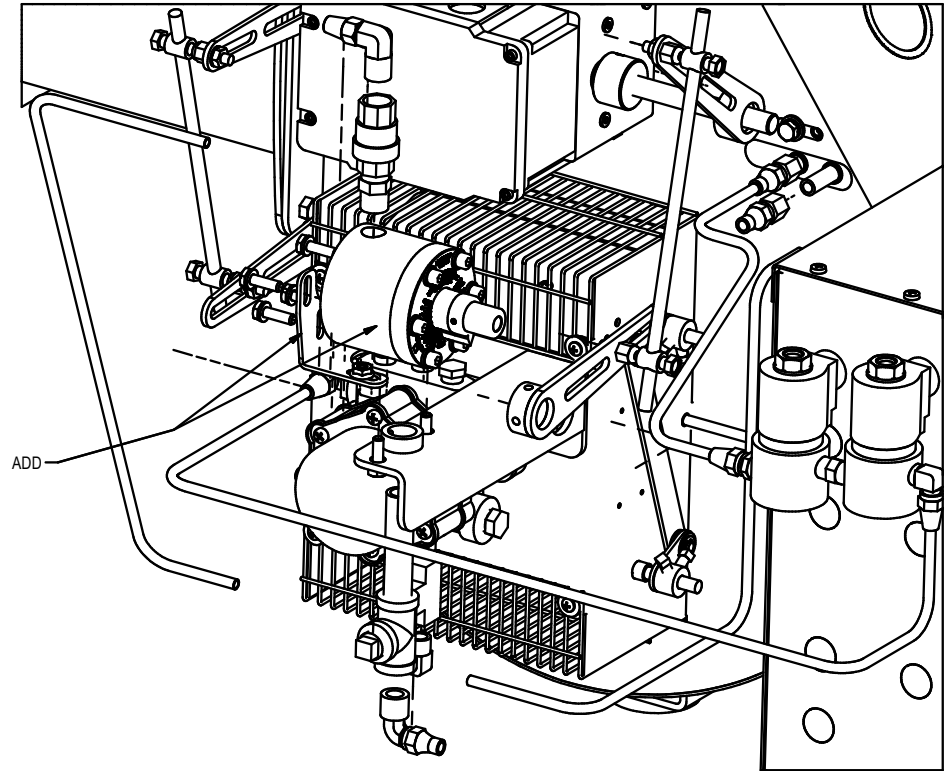
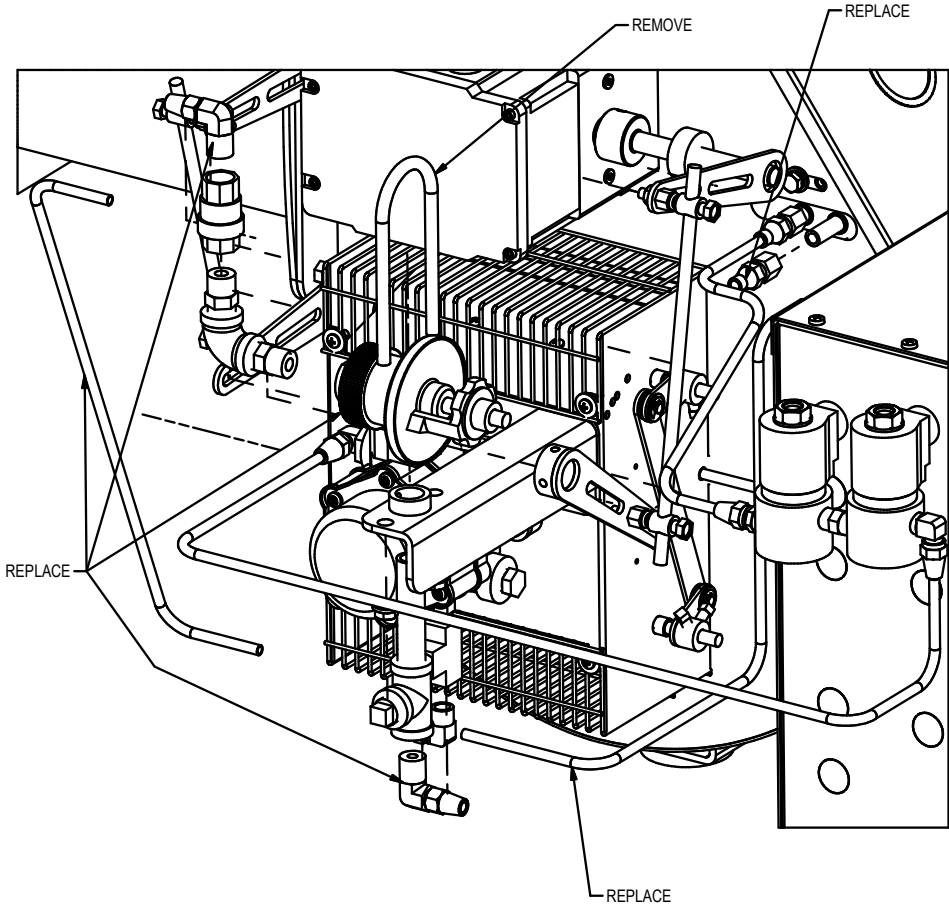

**TOLERANCES**  
 FAB ± 1/32", WELD ± 1/16"  
 ON ALL DIMENSIONS  
 EXCEPT AS NOTED

**Power Flame Inc.**  
 2001 SOUTH 21st STREET  
 PARSONS, KANSAS 67357, USA  
 OFFICE 620.421.0480  
 FAX 620.307.0367  
[www.powerflame.com](http://www.powerflame.com)



**POWER FLAME INC.**  
 AN ASTEC INDUSTRIES COMPANY

DWG. BY:	AG	CHKD. BY:		SCALE:	1 / 3	DATE:	1/16/2024
DO NOT SCALE FROM THIS DRAWING				MATERIAL: SEE BOM TABLE			
TITLE:						DWG. SIZE:	B
S SERIES HAUCK VALVE TO K7 VALVE CONVERSION EXPLODED VIEW						APPROX WEIGHT:	146.45 LBS
						DWG NO.:	I6662MC SHEET 2

REVISION	REVD CHKD	DATE